

LOT 218 COLUMBIA LAKES III
 PHASE 4

COLUMBIA IL 62236
 Site Address: 002438 LAKE SHORE DR

BLDG # 1
 Style/Stories 1.0 One Story
 Quality/Design C C-Average
 Building Use 0100 Single Fami
 Exterior Wall F Frame
 WALL % 100 100%
 Exterior Wall 1
 WALL 1% 000 N/A
 Crawl Sp. Adj C Crawl
 Slab Adjustment
 Basement LC C-Living Qt
 Combination
 Attic Area
 Heat/AC Adj AC Central Air
 Comb Ht/AC Adj
 Fireplace 03 C-Fireplace
 Extra Fireplace 00 N/A
 Res Fixtures 0012 12 Fixtures
 Garage F Frame Garag
 Integral Garage
 Remodeling Adj 01 No Remodeli
 Actual Year Blt 2005
 Effect Year Blt 2005
 Cond/Desir/Util A Res CDU - A
 Township Multpl 04 TOWNSHIP #0
 Funct. Obs. %
 Economic Obs. %
 Observed Cond %
 Obs. Cond. Code
 Combination A
 Comb A Ht/AC
 Unfin Low/Level
 Full Basement F Full Baseme
 # Of Bedrooms 03 Three Bedro
 Sq.Ft.Grđ Area 1594

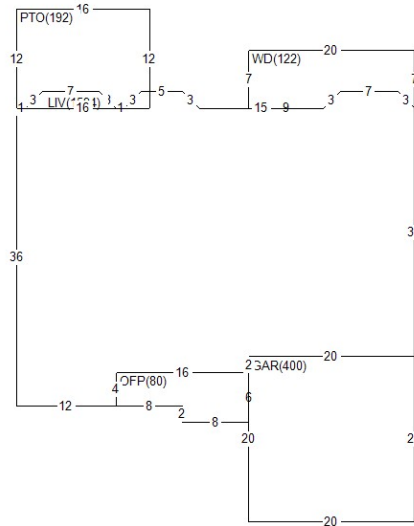

Land Value 52,800
 Misc Value 8,910
 Bldg Value 285,600
 Total Value 347,310
 Value By CAMA

RCN 320,894
 Pct Good 0.8900
 Obsol/Observed 0.0000
 Building Value 285,600

DOCUMENT # DATE QS SALE PRICE
 298982 0705 Q 218,461

PERMIT NO TYPE DATE AMOUNT
 5676 04 0506
 5444 01 0505

Appraiser DG D. Goff
 Appr Date 06/12/20
 Use Code 0040 Imp Res
 NBHD 401.10 COL 1.0 2000-2009
 L100 M100 B228

AREA	FLAT	EFF% E/AREA	ACT% A/AREA	EA/AA HEATED
CRWL	50	1.00	50	50
CONDR	672	1.00	672	672
BSML	900	1.00	900	900
PTO	192	1.00	192	192
LIV	1594	1.00	1594	1594
OFF	80	1.00	80	80
GAR	400	1.00	400	400
WD	122	1.00	122	122

MISC BLDG CODE	DESC	LENGTH	WIDTH	UNITS	ADJ PRICE	EYB DT PCT	ADJUSTMENT	VALUE
1 1 OFF	Open Frame Porch	.00	.00	80.00	29.38	2005 A 11.00	1.00	2,090
2 1 CONDR	Concrete Drivewa	42.00	16.00	672.00	3.65	2005 A 11.00	1.00	2,180
3 1 BRVEN	Brick Veneer	.00	.00	144.00	14.65	2005 A 11.00	1.00	1,880
4 1 WD	Wood Deck	.00	.00	122.00	19.35	2006 A 10.00	1.00	2,130
5 1 PTO	Concrete Patio	12.00	16.00	192.00	3.65	2006 A 10.00	1.00	630

LAND LUSE DESC	ZONING	UNITS TP	PRICE	ADJUSTMENT	CODE/FACTOR	VALUE
1 0401 COLUMBIA LAND #1	CR5	8276.40 S	6.38	TW 1.00	.00 .00 .00	52,800