

PART S 1/2 SE SEC 25 &
PART N 1/2 NE SEC 36

WATERLOO IL 62298

Site Address: 006850 D RD

BLDG # 1
 Style/Stories 1.0 One Story
 Quality/Design C C-Average
 Building Use 0100 Single Fami
 Exterior Wall F Frame
 WALL % 100 100%
 Exterior Wall 1
 WALL 1% 000 N/A
 Crawl Sp. Adj
 Slab Adjustment
 Basement
 Combination
 Attic Area
 Heat/AC Adj AC Central Air
 Comb Ht/AC Adj
 Fireplace 00 N/A
 Extra Fireplace 00 N/A
 Res Fixtures 0009 09 Fixtures
 Garage F Frame Garag
 Integral Garage
 Remodeling Adj 01 No Remodeli
 Actual Year Blt 2000
 Effect Year Blt 2000
 Cond/Desir/Util A Res CDU - A
 Township Multpl 06 TOWNSHIP #0
 Funct. Obs. % 000000
 Economic Obs. % 000000
 Observed Cond % 000000
 Obs. Cond. Code
 Combination A
 Comb A Ht/AC
 Unfin Low/Level
 Full Basement F Full Baseme
 # Of Bedrooms 03 Three Bedro
 Sq.Ft.Grd Area 2028

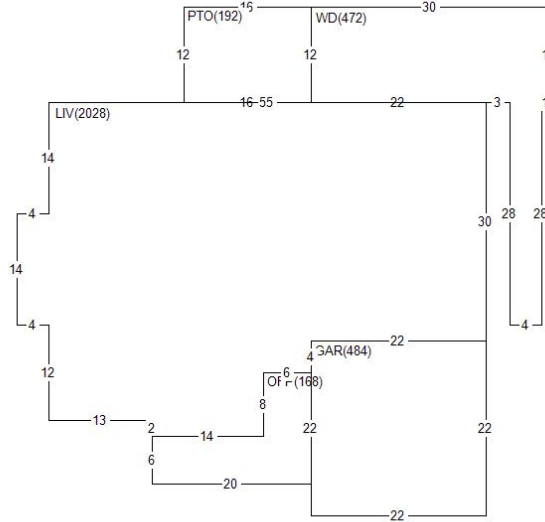

Land Value 58,200
 Misc Value 15,200
 Bldg Value 249,160
 Total Value 322,560
 Value By CAMA

RCN 283,131
 Pct Good 0.8800
 Obsol/Observed 0.0000
 Building Value 249,160

DOCUMENT #	DATE	QS	SALE PRICE
1297	Q		43,425

PERMIT NO	TYPE	DATE	AMOUNT
10218	00	0801	
10218	31	0501	
9781	00	0801	

Appraiser KK K. Kenned
 Appr Date 01/25/22
 Use Code 0011 Imp. Farm
 NBHD 709.08 6/7&8 1.0 2000/NE
 L100 M100 B189

AREA	FLAT	EFF%	E/AREA	ACT%	A/AREA	EA/AA	HEATED
LIV	2028	1.00	2028	1.00	2028	2028	2028
Unfin Low/Level	168	1.00	168	1.00	168	168	
Full Basement	484	1.00	484	1.00	484	484	
# Of Bedrooms	472	1.00	472	1.00	472	472	
Sq.Ft.Grd Area	192	1.00	192	1.00	192	192	
CONDR	418	1.00	418	1.00	418	418	

MISC BLDG CODE	DESC	LENGTH	WIDTH	UNITS	ADJ PRICE	EYB DT	PCT	ADJUSTMENT	VALUE	
1	1 OFP	Open Frame Porch	.00	.00	168.00	23.59	2000 A	12.00	1.00	3,490
3	1 PTO	Concrete Patio	12.00	16.00	192.00	3.65	2001 A	12.00	1.00	620
4	1 WD	Wood Deck	.00	.00	472.00	19.35	2001 A	12.00	1.00	8,040
5	1 PS4C10	Pole Shd 4 Sde C	40.00	30.00	1200.00	13.26	2001 20	85.00	1.00	2,390
6	1 PSCFL	Pole Shd Conc Fl	40.00	30.00	1200.00	3.65	2001 20	85.00	1.00	660

LAND LUSE DESC	ZONING	UNITS TP	PRICE	ADJUSTMENT	CODE/FACTOR	VALUE
1 CJ County Road Cat.	MAL	2.50 R	23280.16	TW 1.00	.00 .00 .00	58,200